

THE DATUM POINT

Newsletter of the
NORTHERN VIRGINIA CHAPTER OF THE
ARCHEOLOGICAL SOCIETY OF VIRGINIA

Chapter Website – www.nvcasv.org

October 2013

Chapter meets at the James Lee Center, 2855 Annandale Rd, Falls Church, 2nd Weds. of each month

FROM THE PRESIDENT – JACK HRANICKY

I have been busy at the Arkfeld site in Frederick County, Virginia. Last week, the crew came up with the following:



The crew named it after the creek; it is now known as the Opequon Lion.

Wm Jack Hranicky

(But Jack, what is it? We'll have that for you in the next exciting issue of THE DATUM POINT! Da, da, Daaaaaaaaa!)

NO OCTOBER MEETING!

FIELD TRIP TO WESTON!

The Chapter is planning a field trip to Weston Farmstead on Saturday, October 5th from 11 AM to 1 PM. The property goes back to a Robert oKingö Carter land grant. The house itself is early 19th Century, with an unusually complete set of outbuildings, including one of the very few slave quarters that you can see in this part of the country. The website for more information is: <http://www.historicweston.org/>.



Arrive by 11 AM and tour the property with docents from the Warrenton Antiquarian Society. There is no admission fee, although donations would be gratefully received. If you want to bring a picnic lunch, feel free but there are several good restaurants in Warrenton.

The ladies of the Warrenton Antiquarian Society will be opening the property just for the Chapter. **To be sure that we will have enough people to make it worth their while, please tell John Kelsey now if you're planning to make the visit and the number of people in your party.** His email is jkelsey@cox.net.

John Howe Imlay



John Howe Imlay, 76, of Culpeper died Saturday, September 28, 2013 at his residence. He was born March 5, 1937 in Maryland Park, MD to the late Nathan T. and Mildred L. Brown Imlay. Mr. Imlay was a member of Bethel Baptist Church. He was also a member of Kemper-Fry-Strother Camp #19, Sons of the Confederate Veterans, Northern VA Chapter of the Archeological Society of VA ðNVCASVö, Archeological Society of Virginia Archeological Society ðASVö, and GCC/IBT, formerly known as LPIU.

He is survived by his loving wife of 51 years, Carol Ann Imlay; two sons, Duane ðTomö Imlay and his wife, Diana of Mechanicsville, MD and John D. Imlay and his wife, Joann of Amissville, VA; two siblings, Mildred Weiser and Linwood J. Imlay and his wife, Marlene; four grandchildren, Joshua, Sarah, Jennifer and Samantha; great grandchildren; and numerous loving and caring nieces and nephews.

The family will receive friends on Wednesday, October 2, 2013 from 6 to 8 pm at Found and Sons Funeral Chapel, 850 Sperryville Pike, Culpeper. A funeral service will be held on Thursday, October 3, 2013 at 11 am at Found and Sons Funeral Chapel with Pastor Adam Meisberger officiating. Interment will follow in Bethel Baptist Church Cemetery.

In lieu of flowers, memorial contributions may be made in his name to Bethel Baptist Church, 6262 Hoover Rd., Reva, VA 22735 &/or Hospice of the Rapidan, PO Box 1715, Culpeper, VA 22701. Found and Sons Funeral Chapel of Culpeper is serving the family.

<http://www.foundandsons.com/obituaries/John-Imlay/#!/Obituary>

OLD COLCHESTER

By the CART Team

After a little over a month of great weather and hard work, CART was able to complete the MTUs in the Flood Plain Survey. The survey consisted of testing the northern boundary of the large prehistoric site along the Occoquan River. Some of the artifacts uncovered ranged from historic nails to prehistoric lithics as well as small pieces of prehistoric pottery. The lithics consisted mainly of quartz but the team uncovered chert flakes as well. We would like to send out a thank you to the CART crew and the volunteers for all their hard work on this survey. In the picture, Jean and Jonathan are finishing up the last MTUs on the Flood Plain Survey.

CART would like to welcome George Mason University student interns to the team. While we will also be taking a number of GMU volunteers who are committing to 40 hours this semester, our four interns are committing to 120 hours of work in order to better learn the skills they will need as they pursue opportunities within the field of archaeology. As you might recall, Colchester was first intensively investigated by George Mason University in the 1980s, well before most of our interns were born!

Marion, our GIS specialist, has been working hard on integrating archaeological data and historical data to create a ðVirtual Colchesterö. The town of Colchester and some of the buildings, from around circa 1760, are overlaid on a modern terrain model. Seen in the middle of the image is the Morris Pound vineyard, and in the lower right are representations of the structures of which we found evidence on the Cemetery Site.



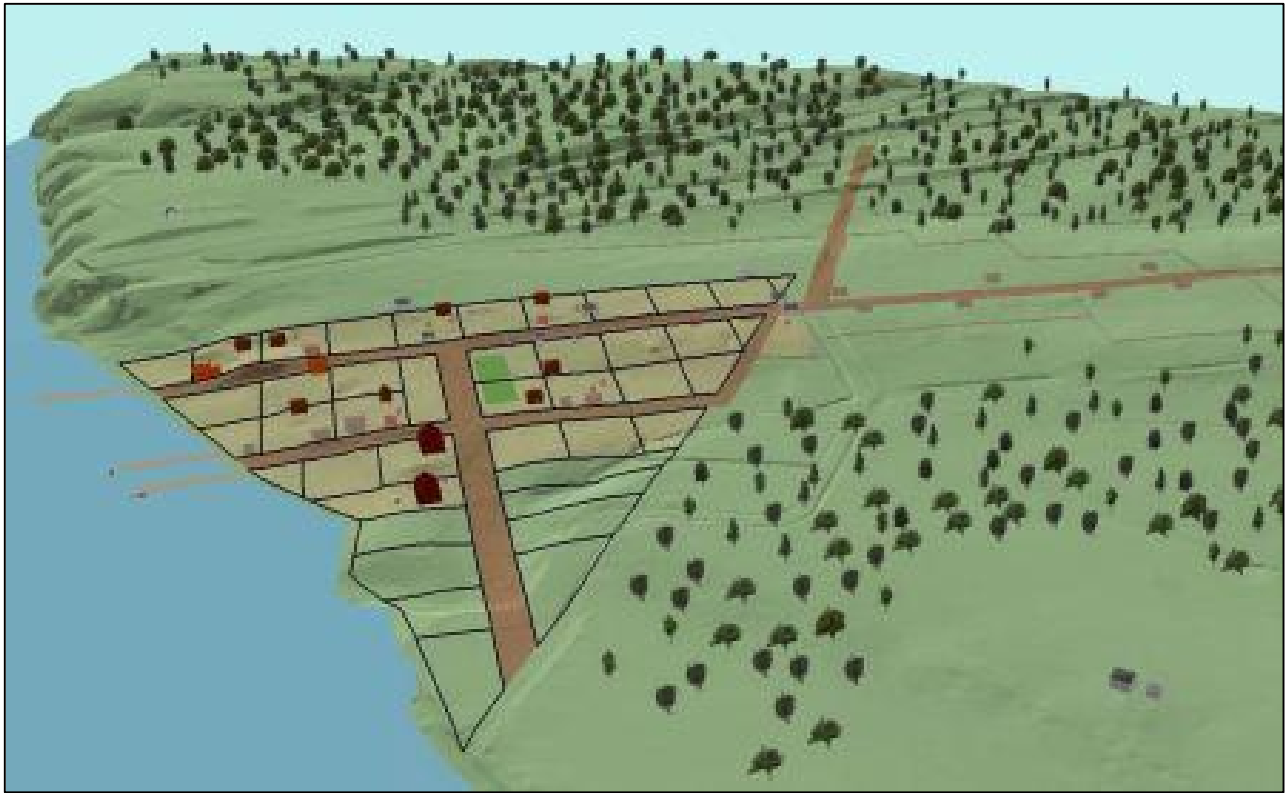

Above: CART map of Colchester on terrain. Below: 1754 map used for base of above graphic.

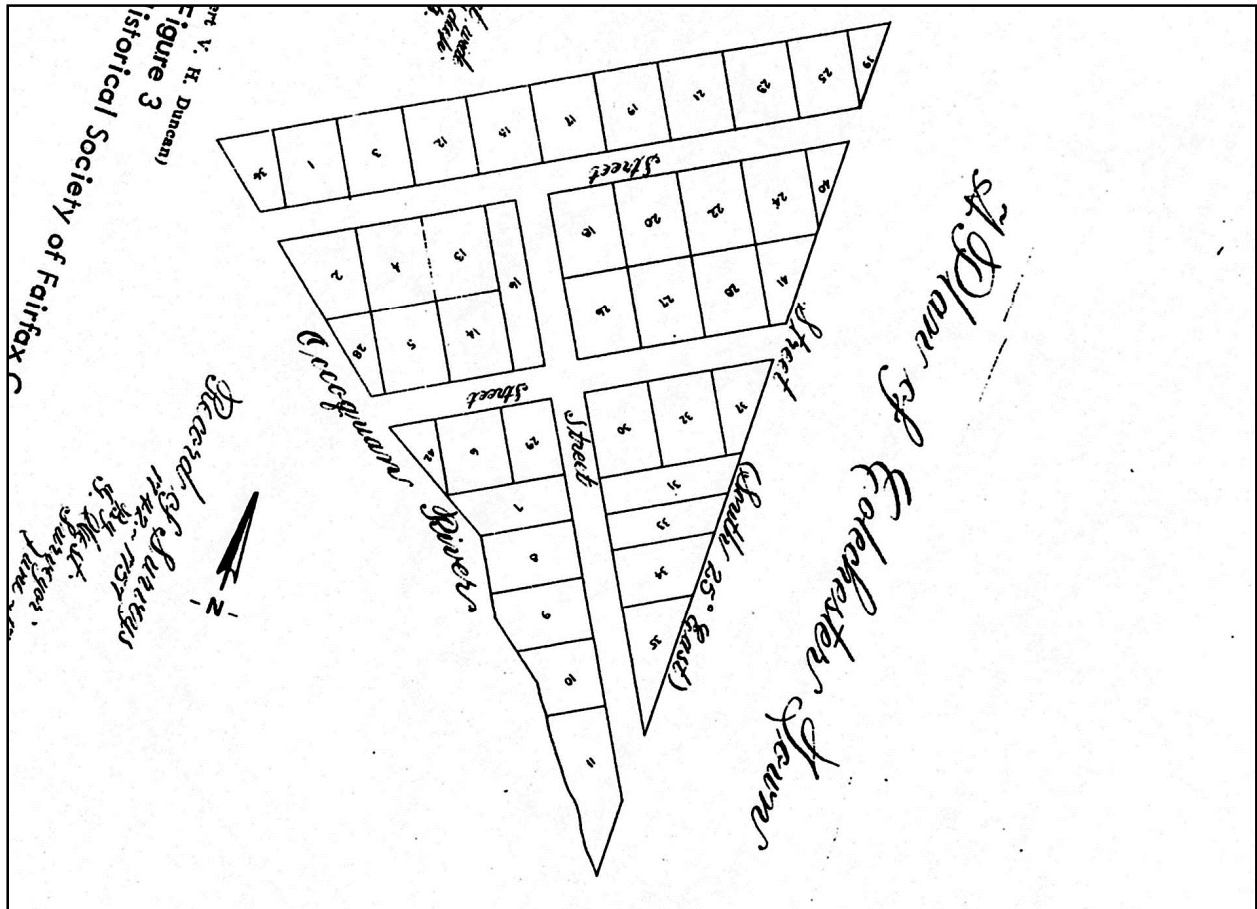

NVC/ASV CHAPTER OFFICERS

President	Jack Hranicky	hranickyj@archeology.org
Vice-President	Chris Havlicek	christo829@juno.com
Treasurer	Isabella Pease	ipease@cox.net
Corresponding Sec.	Maggie Johnson	stillmaggie@cox.net 703-455-6902
Recording Sec.	open	
Editor	Patrick O'Neill	patrickloneill@verizon.net 703-249-9593
Webmaster	Diane Schug-O'Neill	schugoneill@gmail.com
Certification Liaison	Ann Wood	annpwood@verizon.net

Fairfax County Archaeology (FCPA)

Dr. Elizabeth Crowell elizabeth.crowell@fairfaxcounty.gov
703-534-3881

Other Public Archaeological Programs in N. Va.

Mount Vernon	Esther White	ewhite@mountvernon.org
Gunston Hall	Dave Shonyo	archaeology@gunstonhall.org 703-550-0441
Alexandria Museum	Francine Bromberg	Francine.bromberg@alexandriava.gov 703-838-4399 (information)

NVC/ASV MEMBERSHIP APPLICATION

Name: _____

Phone: _____

ADDRESS: _____

EMAIL: _____

Please send *Datum Point* via e-mail

Individual (\$15) _____

Student (\$5) _____

Family (\$17) _____

New _____

Renewal _____

Return to:

**Isabella Pease, Treasurer, NVC/ASV
8304 Graceway Drive
Lorton, VA 22079**

THE DATUM POINT

Northern Virginia Chapter
Archeological Society of Virginia
2855 Annandale Rd.
Falls Church, VA 22042

ADDRESS CORRECTION REQUESTED

**Help NVC-ASV Save Postage and be GREEN!
Have the Datum Point emailed to you!**